

NMN-GTW-0003_01 Green Line Metro Upgrade – Line B

APPENDIX 3: Line B Study Area Scenario 3 Platform Drawings

Initial Concept Designs

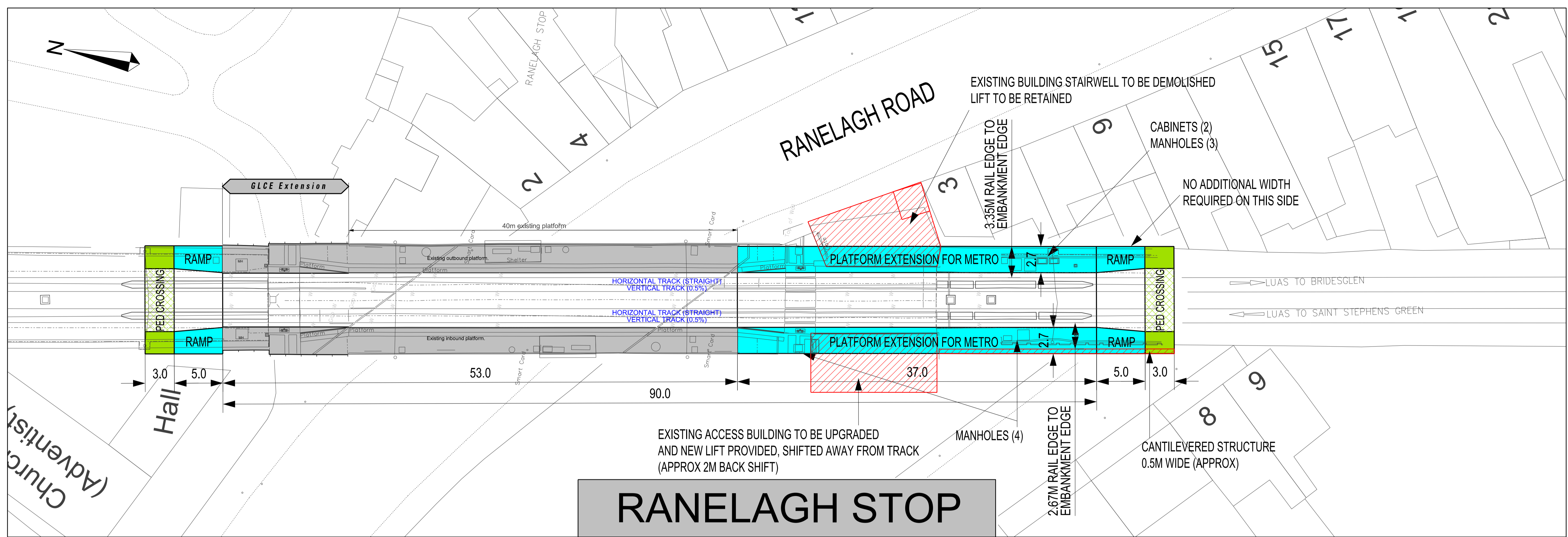

RANELAGH STOP



The information contained herein has been provided by TII but does not purport to be comprehensive or final. Recipients should not rely on the information. Neither TII nor any of its directors, officers, employees, agents, stakeholders or advisers make any representation or warranty as to, or accept any liability or responsibility in relation to, the adequacy, accuracy, reasonableness or completeness of the information provided as part of this document or any matter on which the information is based (including but not limited to loss or damage arising as a result of reliance by recipients on the information or any part of it). Any liabilities are hereby expressly disclaimed.

© National Roads Authority (NRA) 2017. This drawing is confidential and the copyright in it is owned by NRA. This drawing must not be either loaned, copied or otherwise reproduced in whole or in part or used for any purpose without the prior permission of NRA.

Transport Infrastructure Ireland (TII) is an operational name of the National Roads Authority.

© Ordnance Survey Ireland and Government of Ireland. All O.S. data used for plans are printed under Ordnance Survey no. O.S.6417. All elevations are in metres and relate to OSI Geoid Model (OSGM02) Malin Head as defined by existing Project Control. All Co-ordinates are in Irish Transverse Mercator Grid (ITM) as defined by OSI active GPS station Tallaght College (TLLG).

REV	DATE	DESCRIPTION	BY	CHK	APD
B01	05.04.2017	ISSUED FOR INFORMATION	DHU	MCO	PHI

Transport Infrastructure Ireland
National Roads Authority

Prepared by: DHU
Designed by: DHU
Approved by: PHI

Prepared Check by: MCO
Design Check by: MCO
As Built by:

Date: APRIL 2017
Scales: AS SHOWN
Sheet: A1

LOCATION		RANELAGH LUAS STOP			CHAINAGE
DRAWING TITLE					
RANELAGH PLATFORM EXTENSION UPGRADE TO 90M FOR METRO STOP					
STAGE	LINE	CONTRACT	ELEMENT	DRW NO	DRW REV
B	NMN	0000	ML	S0411	B01

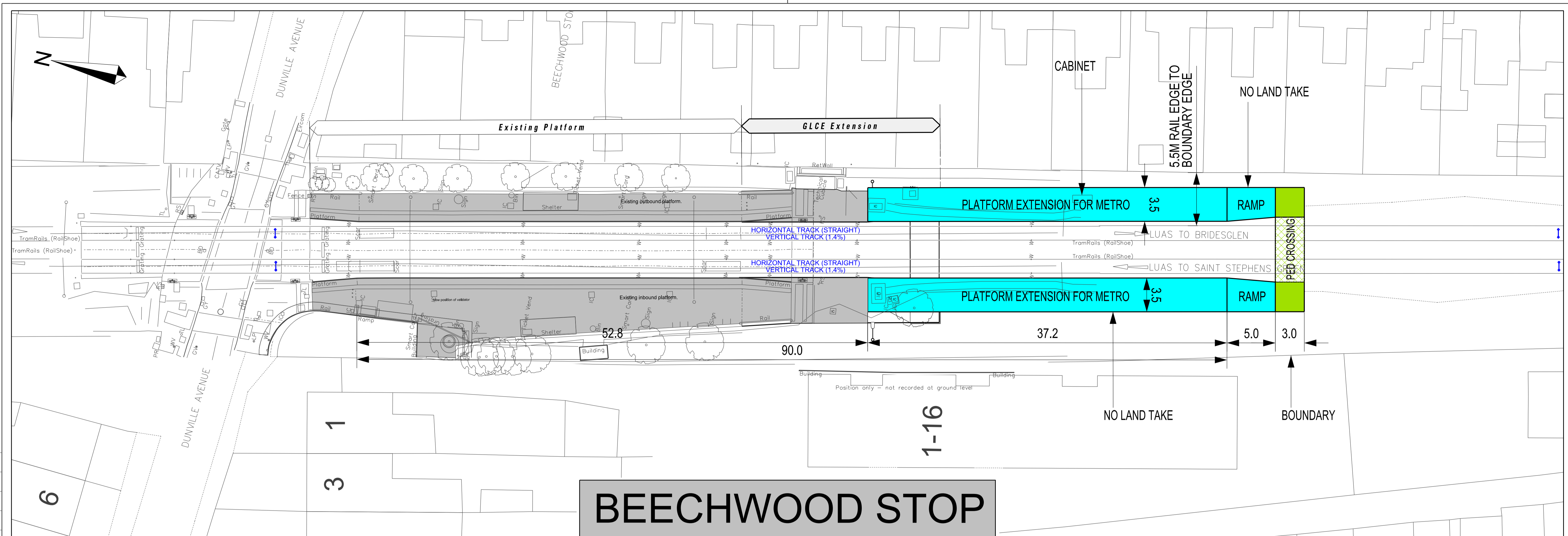

BEECHWOOD STOP



The information contained herein has been provided by TII but does not purport to be comprehensive or final. Recipients should not rely on the information. Neither TII nor any of its directors, officers, employees, agents, stakeholders or advisers make any representation or warranty as to, or accept any liability or responsibility in relation to, the adequacy, accuracy, reasonableness or completeness of the information provided as part of this document or any matter on which the information is based (including but not limited to loss or damage arising as a result of reliance by recipients on the information or any part of it). Any liabilities are hereby expressly disclaimed.

© National Roads Authority (NRA) 2017. This drawing is confidential and the copyright in it is owned by NRA. This drawing must not be either loaned, copied or otherwise reproduced in whole or in part or used for any purpose without the prior permission of NRA.

Transport Infrastructure Ireland (TII) is an operational name of the National Roads Authority.

© Ordnance Survey Ireland and Government of Ireland. All O.S. data used for plans are printed under Ordnance Survey no. O.S.6417. All elevations are in metres and relate to OSI Geoid Model (OSGM02) Malin Head as defined by existing Project Control. All Co-ordinates are in Irish Transverse Mercator Grid (ITM) as defined by OSI active GPS station Tallaght College (TLLG).

REV	DATE	DESCRIPTION	BY	CHK	APD
B01	05.04.2017	ISSUED FOR INFORMATION	DHU	MCO	PHI

Bechtel Group (Ireland) Ltd
 10th Floor, 100 St. James's Street
 Dublin 8, Ireland
 Tel: +353 1 464 5000
 Fax: +353 1 464 5001
 www.tii.ie

METRO

PREPARED BY	DHU	DESIGNED BY	DHU	APPROVED BY	PHI
PREPARED CHECK BY	MCO	DESIGN CHECK BY	MCO	AS BUILT BY	
DATE:	APRIL 2017	SCALES:	AS SHOWN	SHEET	A1

LOCATION		BEECHWOOD LUAS STOP		CHAINAGE
DRAWING TITLE				
BEECHWOOD PLATFORM EXTENSION UPGRADE TO 90M FOR METRO STOP				
STAGE	LINE	CONTRACT	ELEMENT	DRW NO
B	NMN	0000	ML	S0511
				DRW REV
				B01

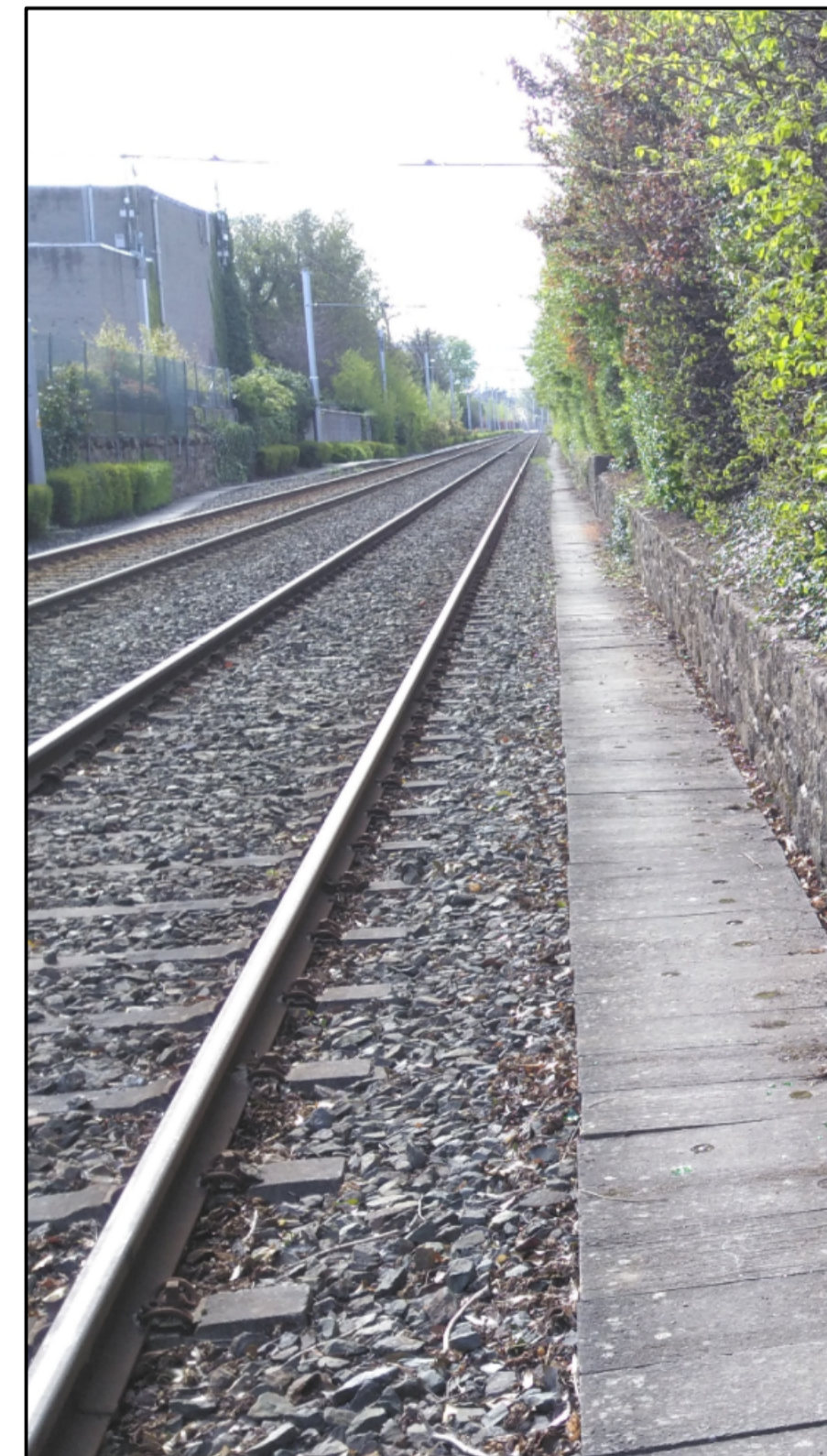
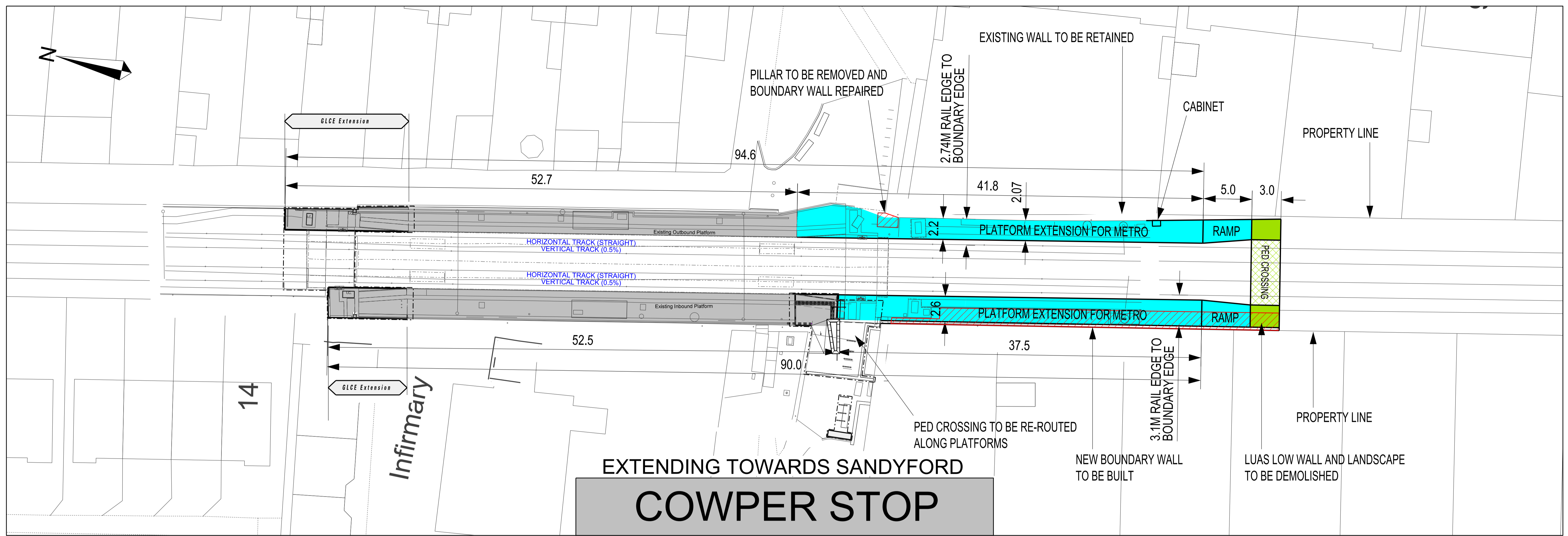

The information contained herein has been provided by TII but does not purport to be comprehensive or final. Recipients should not rely on the information. Neither TII nor any of its directors, officers, employees, agents, stakeholders or advisers make any representation or warranty as to, or accept any liability or responsibility in relation to, the adequacy, accuracy, reasonableness or completeness of the information provided as part of this document or any matter on which the information is based (including but not limited to loss or damage arising as a result of reliance by recipients on the information or any part of it). Any liabilities are hereby expressly disclaimed.

© National Roads Authority (NRA) 2017. This drawing is confidential and the copyright in it is owned by NRA. This drawing must not be either loaned, copied or otherwise reproduced in whole or in part or used for any purpose without the prior permission of NRA. Transport Infrastructure Ireland (TII) is an operational name of the National Roads Authority.

© Ordnance Survey Ireland and Government of Ireland. All O.S. data used for plans are printed under Ordnance Survey no. O.S.6417. All elevations are in metres and relate to OSI Geoid Model (OSGM02) Malin Head as defined by existing Project Control. All Co-ordinates are in Irish Transverse Mercator Grid (ITM) as defined by OSI active GPS station Tallaght College (TLLG).

REV	DATE	DESCRIPTION	BY	CHK	APD
B01	05.04.2017	ISSUED FOR INFORMATION	DHU	MCO	PHJ

TII
Transport Infrastructure Ireland

Blas na Gaeil: An t-Éireann
Blaith na Gaeil: Éire
Blaith na Gaeil: Éire
Párlaimint na hÉireann
Dáil Éireann
1998-2017
Phone: +353 1 446 5000
Fax: +353 1 446 5001
www.tii.ie

PREPARED BY	DHU	DESIGNED BY	DHU	APPROVED BY	PHJ
PREPARED CHECK BY	MCO	DESIGN CHECK BY	MCO	AS BUILT BY	
DATE:	APRIL 2017	SCALES:	AS SHOWN	SHEET	A1

LOCATION		COWPER LUAS STOP			CHAINAGE
DRAWING TITLE					
COWPER PLATFORM EXTENSION UPGRADE TO 90M FOR METRO STOP					
STAGE	LINE	CONTRACT	ELEMENT	DRW NO	DRW REV
B	NMN	0000	ML	S0611	B01

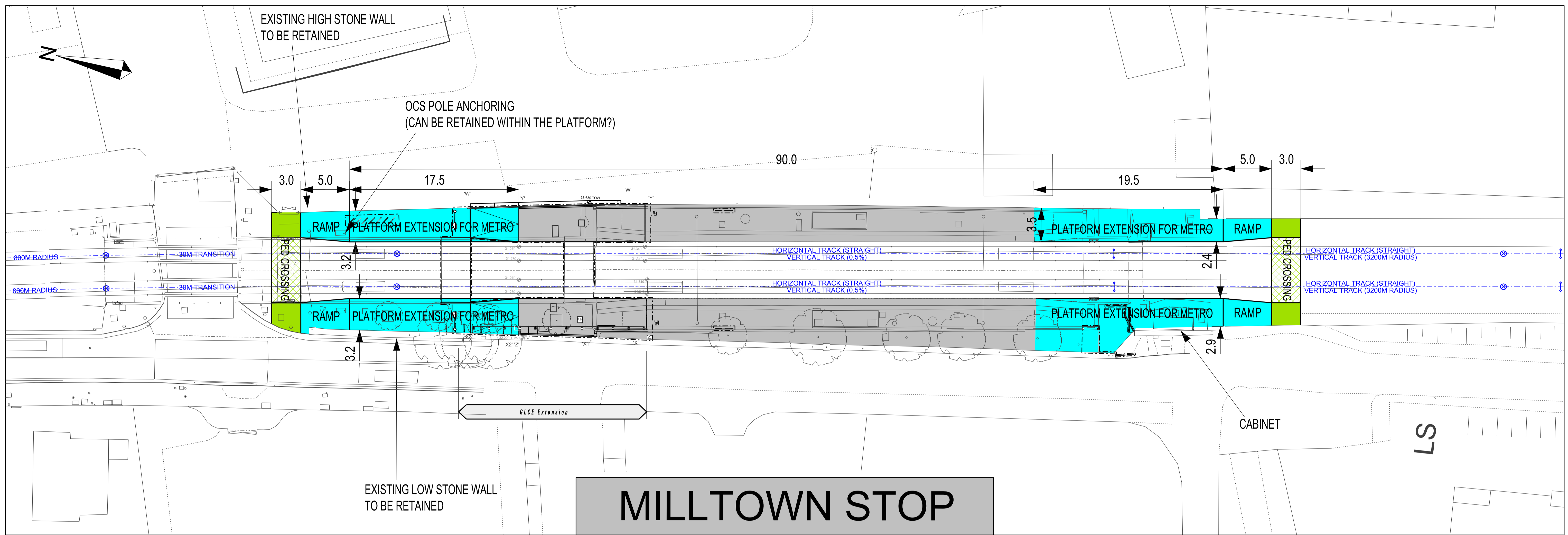

MILLTOWN STOP



The information contained herein has been provided by TII but does not purport to be comprehensive or final. Recipients should not rely on the information. Neither TII nor any of its directors, officers, employees, agents, stakeholders or advisers make any representation or warranty as to, or accept any liability or responsibility in relation to, the adequacy, accuracy, reasonableness or completeness of the information provided as part of this document or any matter on which the information is based (including but not limited to loss or damage arising as a result of reliance by recipients on the information or any part of it). Any liabilities are hereby expressly disclaimed.

© National Roads Authority (NRA) 2017. This drawing is confidential and the copyright in it is owned by NRA. This drawing must not be either loaned, copied or otherwise reproduced in whole or in part or used for any purpose without the prior permission of NRA.

Transport Infrastructure Ireland (TII) is an operational name of the National Roads Authority.

© Ordnance Survey Ireland and Government of Ireland. All O.S. data used for plans are printed under Ordnance Survey no. O.S.6417. All elevations are in metres and relate to OSI Geoid Model (OSGM02) Malin Head as defined by existing Project Control. All Co-ordinates are in Irish Transverse Mercator Grid (ITM) as defined by OSI active GPS station Tallaght College (TLLG).

REV	DATE	DESCRIPTION	BY	CHK	APD
B01	05.04.2017	ISSUED FOR INFORMATION	DHU	MCO	PHI



METRO

PREPARED BY	DHU	DESIGNED BY	DHU	APPROVED BY	PHI
PREPARED CHECK BY	MCO	DESIGN CHECK BY	MCO	AS BUILT BY	
DATE:	APRIL 2017	SCALES:	AS SHOWN	SHEET	A1

LOCATION	MILLTOWN LUAS STOP				CHAINAGE
DRAWING TITLE	MILLTOWN PLATFORM EXTENSION UPGRADE TO 90M FOR METRO STOP				
STAGE	LINE	CONTRACT	ELEMENT	DRW NO	DRW REV
B	NMN	0000	ML	S0711	B01

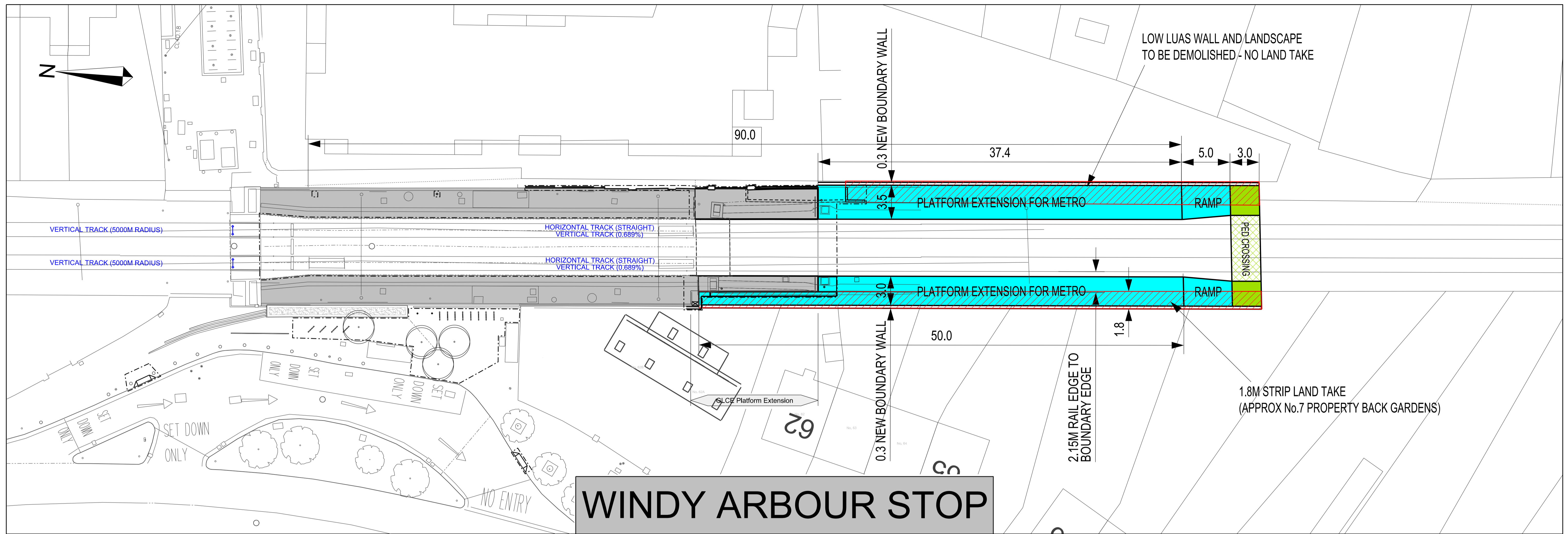

WINDY ARBOUR STOP



The information contained herein has been provided by TII but does not purport to be comprehensive or final. Recipients should not rely on the information. Neither TII nor any of its directors, officers, employees, agents, stakeholders or advisers make any representation or warranty as to, or accept any liability or responsibility in relation to, the adequacy, accuracy, reasonableness or completeness of the information provided as part of this document or any matter on which the information is based (including but not limited to loss or damage arising as a result of reliance by recipients on the information or any part of it). Any liabilities are hereby expressly disclaimed.

© National Roads Authority (NRA) 2017. This drawing is confidential and the copyright in it is owned by NRA. This drawing must not be either loaned, copied or otherwise reproduced in whole or in part or used for any purpose without the prior permission of NRA.

Transport Infrastructure Ireland (TII) is an operational name of the National Roads Authority.

© Ordnance Survey Ireland and Government of Ireland. All O.S. data used for plans are printed under Ordnance Survey no. O.S.6417. All elevations are in metres and relate to OSI Geoid Model (OSGM02) Malin Head as defined by existing Project Control. All Co-ordinates are in Irish Transverse Mercator Grid (ITM) as defined by OSI active GPS station Tallaght College (TLLG).

REV	DATE	DESCRIPTION	BY	CHK	APD
B01	05.04.2017	ISSUED FOR INFORMATION	DHU	MCO	PHI



METRO

PREPARED BY	DHU	DESIGNED BY	DHU	APPROVED BY	PHI
PREPARED CHECK BY	MCO	DESIGN CHECK BY	MCO	AS BUILT BY	
DATE:	APRIL 2017	SCALES:	AS SHOWN	SHEET	A1

LOCATION	WINDY ARBOUR LUAS STOP			CHAINAGE	
DRAWING TITLE	WINDY ARBOUR PLATFORM EXTENSION UPGRADE TO 90M FOR METRO STOP				
STAGE	LINE	CONTRACT	ELEMENT	DRW NO	DRW REV
B	NMN	0000	ML	S0811	B01

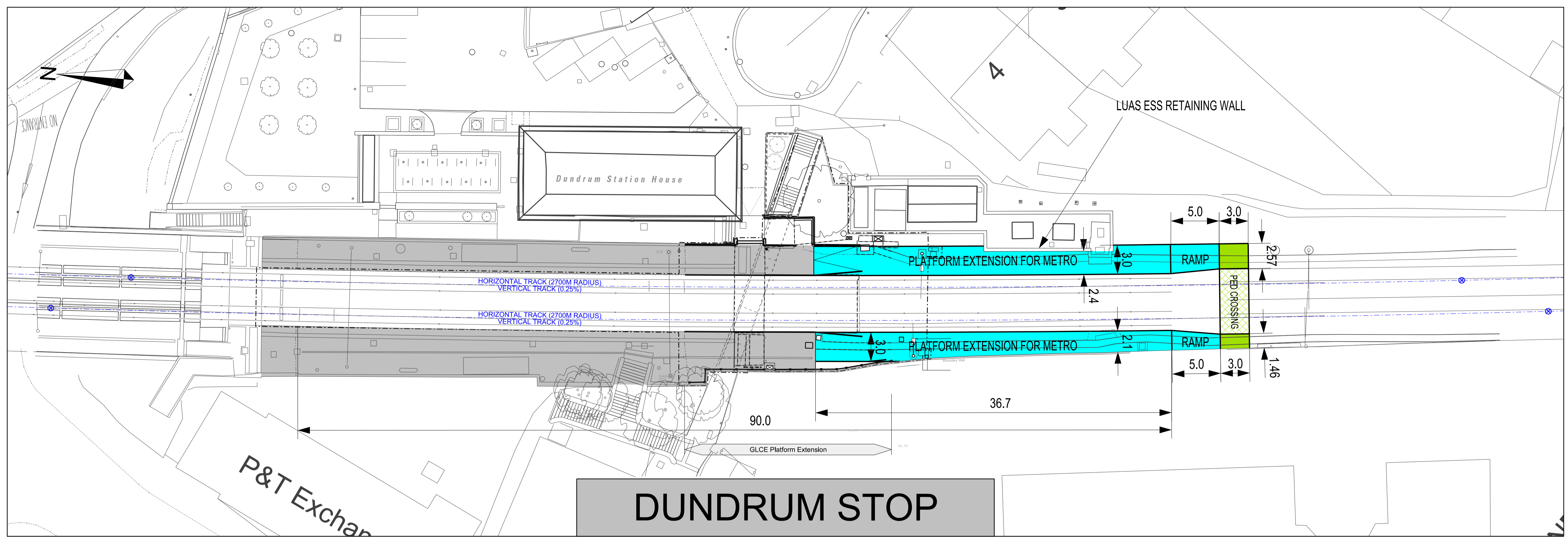

DUNDRUM STOP



The information contained herein has been provided by TII but does not purport to be comprehensive or final. Recipients should not rely on the information. Neither TII nor any of its directors, officers, employees, agents, stakeholders or advisers make any representation or warranty as to, or accept any liability or responsibility in relation to, the adequacy, accuracy, reasonableness or completeness of the information provided as part of this document or any matter on which the information is based (including but not limited to loss or damage arising as a result of reliance by recipients on the information or any part of it). Any liabilities are hereby expressly disclaimed.

© National Roads Authority (NRA) 2017. This drawing is confidential and the copyright in it is owned by NRA. This drawing must not be either loaned, copied or otherwise reproduced in whole or in part or used for any purpose without the prior permission of NRA.

Transport Infrastructure Ireland (TII) is an operational name of the National Roads Authority.

© Ordnance Survey Ireland and Government of Ireland. All O.S. data used for plans are printed under Ordnance Survey no. O.S.6417. All elevations are in metres and relate to OSI Geoid Model (OSGM02) Malin Head as defined by existing Project Control. All Co-ordinates are in Irish Transverse Mercator Grid (ITM) as defined by OSI active GPS station Tallaght College (TLLG).

REV	DATE	DESCRIPTION	BY	CHK	APD
B01	05.04.2017	ISSUED FOR INFORMATION	DHU	MCO	PHI



PREPARED BY	DHU	DESIGNED BY	DHU	APPROVED BY	PHI
PREPARED CHECK BY	MCO	DESIGN CHECK BY	MCO	AS BUILT BY	
DATE:	APRIL 2017	SCALES:	AS SHOWN	SHEET	A1

LOCATION	DUNDRUM LUAS STOP				CHAINAGE
DRAWING TITLE	DUNDRUM PLATFORM EXTENSION UPGRADE TO 90M FOR METRO STOP				
STAGE	LINE	CONTRACT	ELEMENT	DRW NO	DRW REV
B	NMN	0000	ML	S0911	B01

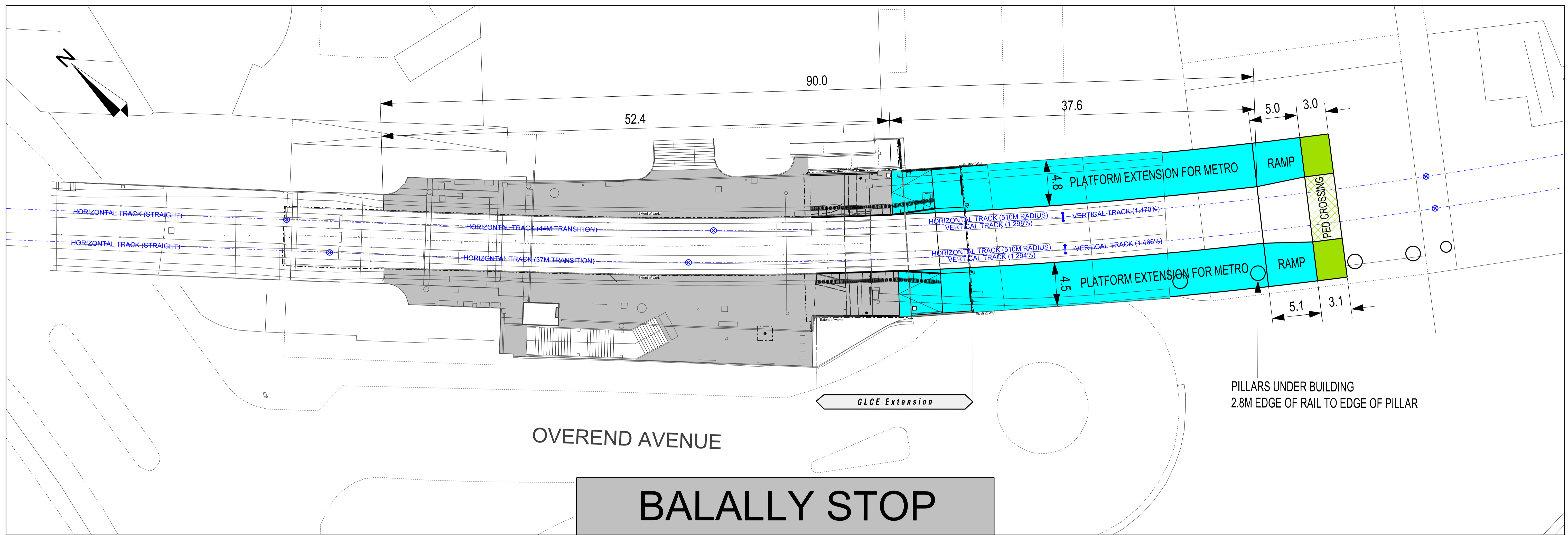

The information contained herein has been provided by TII but does not purport to be comprehensive or final. Recipients should not rely on the information. Neither TII nor any of its directors, officers, employees, agents, stakeholders or advisers make any representation or warranty as to, or accept any liability or responsibility in relation to, the adequacy, accuracy, reasonableness or completeness of the information provided as part of this document or any matter on which the information is based (including but not limited to loss or damage arising as a result of reliance by recipients on the information or any part of it). Any liabilities are hereby expressly disclaimed.

© National Roads Authority (NRA) 2017. This drawing is confidential and the copyright in it is owned by NRA. This drawing must not be either loaned, copied or otherwise reproduced in whole or in part or used for any purpose without the prior permission of NRA. Transport Infrastructure Ireland (TII) is an operational name of the National Roads Authority.

© Ordnance Survey Ireland and Government of Ireland. All O.S. data used for plans are printed under Ordnance Survey no. O.S.6417. All elevations are in metres and relate to OSI Geoid Model (OSGM02) Malin Head as defined by existing Project Control. All Co-ordinates are in Irish Transverse Mercator Grid (ITM) as defined by OSI active GPS station Tallaght College (TLLG).

REV	DATE	DESCRIPTION	BY	CHK	APD
B01	05.04.2017	ISSUED FOR INFORMATION	DHU	MCO	PHI

Transport Infrastructure Ireland
National Roads Authority

METRO

Prepared by: DHU
Designed by: DHU
Approved by: PHI

Prepared Check by: MCO
Design Check by: MCO
As Built by:

Date: APRIL 2017
Scales: AS SHOWN
Sheet: A1

LOCATION	BALALLY LUAS STOP				CHAINAGE
DRAWING TITLE	BALALLY PLATFORM EXTENSION UPGRADE TO 90M FOR METRO STOP				
STAGE	LINE	CONTRACT	ELEMENT	DRW NO	DRW REV
B	NMN	0000	ML	S1011	B01

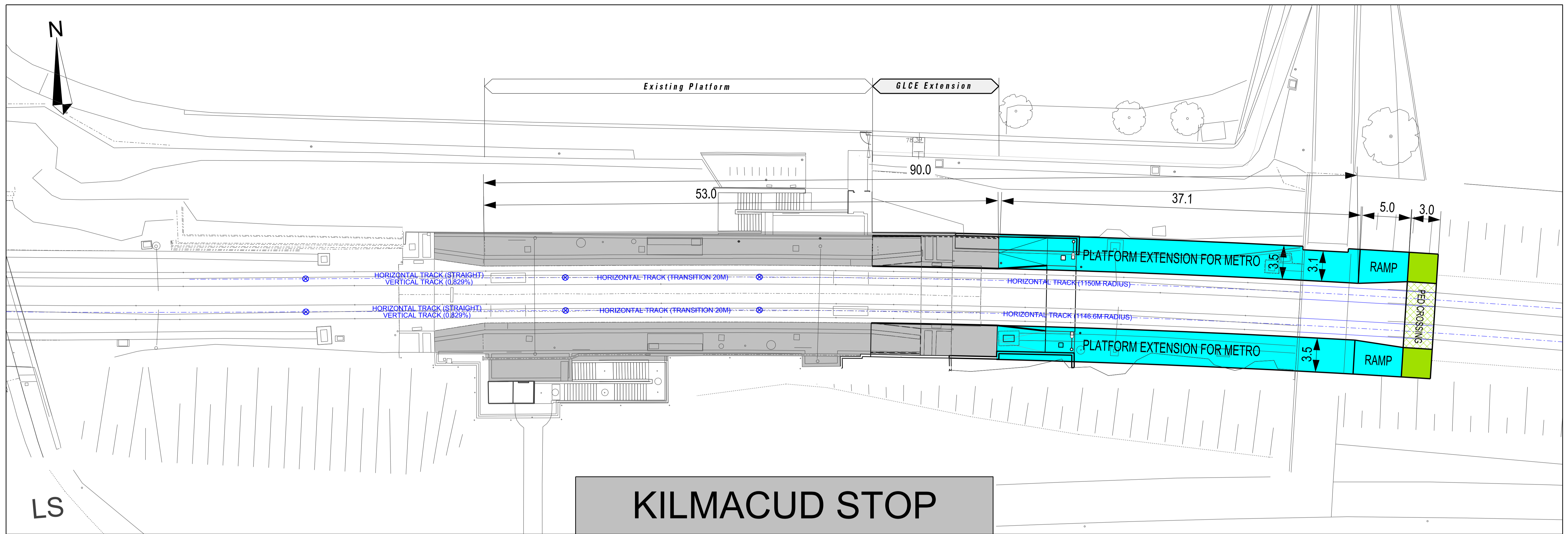

KILMACUD STOP



The information contained herein has been provided by TII but does not purport to be comprehensive or final. Recipients should not rely on the information. Neither TII nor any of its directors, officers, employees, agents, stakeholders or advisers make any representation or warranty as to, or accept any liability or responsibility in relation to, the adequacy, accuracy, reasonableness or completeness of the information provided as part of this document or any matter on which the information is based (including but not limited to loss or damage arising as a result of reliance by recipients on the information or any part of it). Any liabilities are hereby expressly disclaimed.

© National Roads Authority (NRA) 2017. This drawing is confidential and the copyright in it is owned by NRA. This drawing must not be either loaned, copied or otherwise reproduced in whole or in part or used for any purpose without the prior permission of NRA.

Transport Infrastructure Ireland (TII) is an operational name of the National Roads Authority.

© Ordnance Survey Ireland and Government of Ireland. All O.S. data used for plans are printed under Ordnance Survey no. O.S.6417. All elevations are in metres and relate to OSI Geoid Model (OSGM02) Malin Head as defined by existing Project Control. All Co-ordinates are in Irish Transverse Mercator Grid (ITM) as defined by OSI active GPS station Tallaght College (TLLG).

REV	DATE	DESCRIPTION	BY	CHK	APD
B01	05.04.2017	ISSUED FOR INFORMATION	DHU	MCO	PHI

Transport Infrastructure Ireland
Brick Six O'Clock on Palace
Gate, Dublin 4
Dublin Area Office
Parnham Street
Dublin 4, Ireland
D08 DK10
Phone: +353 1 446 5000
Fax: +353 1 446 5001
www.tii.ie

METRO

PREPARED BY	DHU	DESIGNED BY	DHU	APPROVED BY	PHI
PREPARED CHECK BY	MCO	DESIGN CHECK BY	MCO	AS BUILT BY	
DATE:	APRIL 2017	SCALES:	AS SHOWN	SHEET	A1

LOCATION		KILMACUD LUAS STOP			CHAINAGE
DRAWING TITLE					
KILMACUD PLATFORM EXTENSION UPGRADE TO 90M FOR METRO STOP					
STAGE	LINE	CONTRACT	ELEMENT	DRW NO	DRW REV
B	NMN	0000	ML	S1111	B01

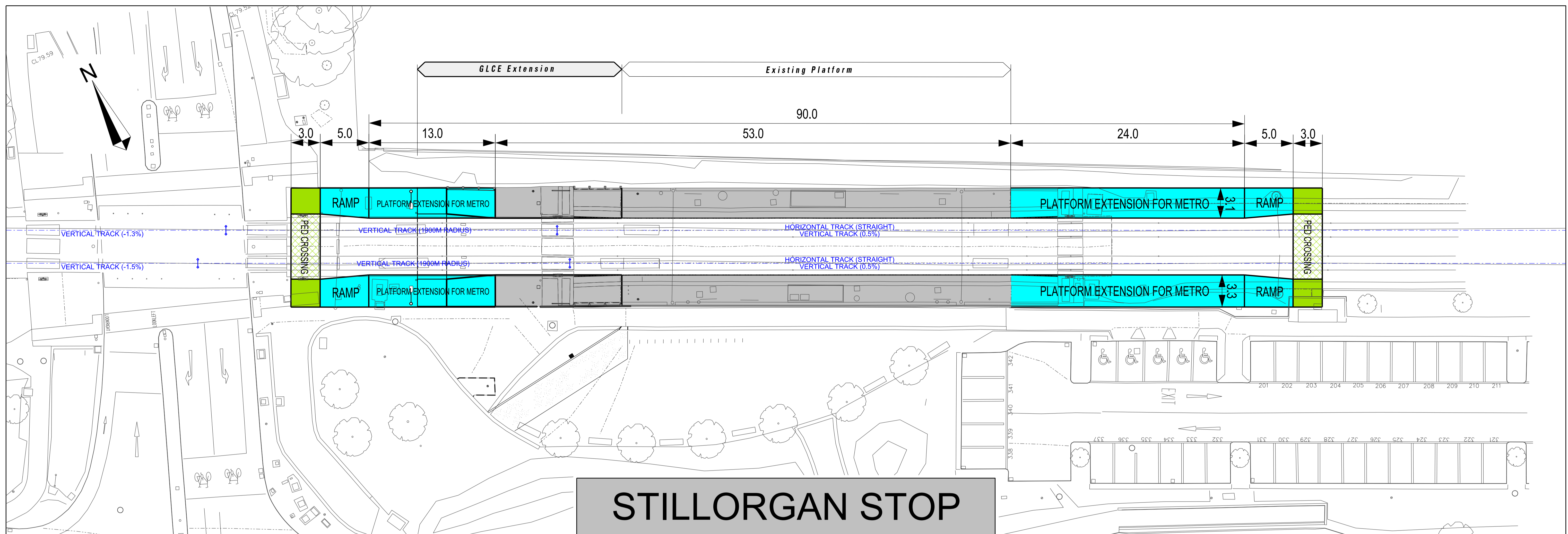

STILLORGAN STOP



The information contained herein has been provided by TII but does not purport to be comprehensive or final. Recipients should not rely on the information. Neither TII nor any of its directors, officers, employees, agents, stakeholders or advisers make any representation or warranty as to, or accept any liability or responsibility in relation to, the adequacy, accuracy, reasonableness or completeness of the information provided as part of this document or any matter on which the information is based (including but not limited to loss or damage arising as a result of reliance by recipients on the information or any part of it). Any liabilities are hereby expressly disclaimed.

© National Roads Authority (NRA) 2017. This drawing is confidential and the copyright in it is owned by NRA. This drawing must not be either loaned, copied or otherwise reproduced in whole or in part or used for any purpose without the prior permission of NRA.

Transport Infrastructure Ireland (TII) is an operational name of the National Roads Authority.

© Ordnance Survey Ireland and Government of Ireland. All O.S. data used for plans are printed under Ordnance Survey no. O.S.6417. All elevations are in metres and relate to OSI Geoid Model (OSGM02) Malin Head as defined by existing Project Control. All Co-ordinates are in Irish Transverse Mercator Grid (ITM) as defined by OSI active GPS station Tallaght College (TLLG).

REV	DATE	DESCRIPTION	BY	CHK	APD
B01	05.04.2017	ISSUED FOR INFORMATION	DHU	MCO	PHI

Blaise Gille O'Connell na Páirc
 2000 Clonsilla na Bóithé
 Bally Alley Clonsilla N. Co. DU
 Páirc na n-Éireann
 Clonsilla, Co. DU
 D18 0K10
 Phone: +353 1 946 5000
 Fax: +353 1 946 5001
 www.tii.ie

METRO

PREPARED BY	DHU	DESIGNED BY	DHU	APPROVED BY	PHI
PREPARED CHECK BY	MCO	DESIGN CHECK BY	MCO	AS BUILT BY	
DATE:	APRIL 2017	SCALES:	AS SHOWN	SHEET	A1

LOCATION		STILLORGAN LUAS STOP			CHAINAGE
DRAWING TITLE					
STILLORGAN PLATFORM EXTENSION UPGRADE TO 90M FOR METRO STOP					
STAGE	LINE	CONTRACT	ELEMENT	DRW NO	DRW REV
B	NMN	0000	ML	S1211	B01

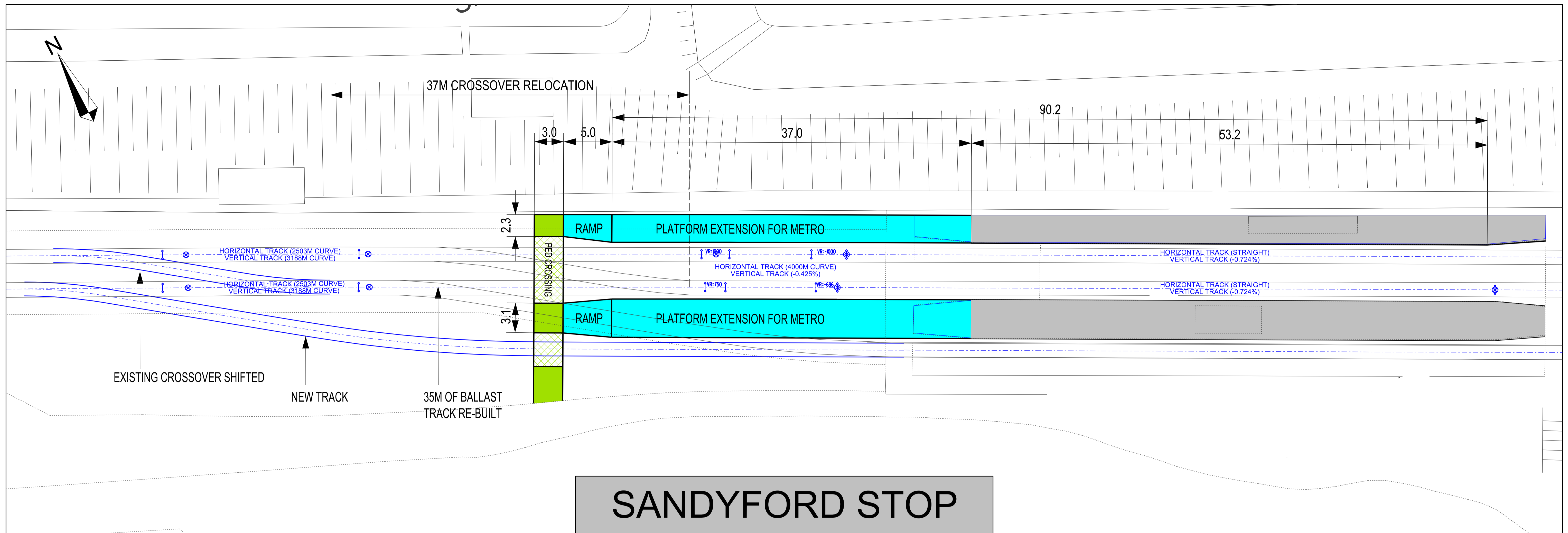

The information contained herein has been provided by TII but does not purport to be comprehensive or final. Recipients should not rely on the information. Neither TII nor any of its directors, officers, employees, agents, stakeholders or advisers make any representation or warranty as to, or accept any liability or responsibility in relation to, the adequacy, accuracy, reasonableness or completeness of the information provided as part of this document or any matter on which the information is based (including but not limited to loss or damage arising as a result of reliance by recipients on the information or any part of it). Any liabilities are hereby expressly disclaimed.

© National Roads Authority (NRA) 2017. This drawing is confidential and the copyright in it is owned by NRA. This drawing must not be either loaned, copied or otherwise reproduced in whole or in part or used for any purpose without the prior permission of NRA.

Transport Infrastructure Ireland (TII) is an operational name of the National Roads Authority.

© Ordnance Survey Ireland and Government of Ireland. All O.S. data used for plans are printed under Ordnance Survey no. O.S.6417. All elevations are in metres and relate to OSI Geoid Model (OSGM02) Malin Head as defined by existing Project Control. All Co-ordinates are in Irish Transverse Mercator Grid (ITM) as defined by OSI active GPS station Tallaght College (TLLG).

REV	DATE	DESCRIPTION	BY	CHK	APD
B01	05.04.2017	ISSUED FOR INFORMATION	DHU	MCO	PHI

TII
Transport Infrastructure Ireland

METRO

PREPARED BY	DHU	DESIGNED BY	DHU	APPROVED BY	PHI
PREPARED CHECK BY	MCO	DESIGN CHECK BY	MCO	AS BUILT BY	
DATE:	APRIL 2017	SCALES:	AS SHOWN	SHEET	A1

LOCATION	SANDYFORD LUAS STOP			CHAINAGE	
DRAWING TITLE	SANDYFORD PLATFORM EXTENSION UPGRADE TO 90M FOR METRO STOP				
STAGE	LINE	CONTRACT	ELEMENT	DRW NO	DRW REV
B	NMN	0000	ML	S1311	B01